

# ECO-LITE

P R O D U C T S

## ECO25400085 Downlight

### DESCRIPTION

- Lighting is smooth and comfortable while using 50% less energy than the common CFL downlight.
- Eco-friendly, no lead or mercury
- Designed to install into an existing downlights mounting frame and converts them into energy efficient LED downlights to save anywhere from 35% up to 75% on energy cost.
- Ideally suited for use in commercial, retail and other architectural applications
- Available with dedicated Emergency Battery Back-up
- ETL Listed

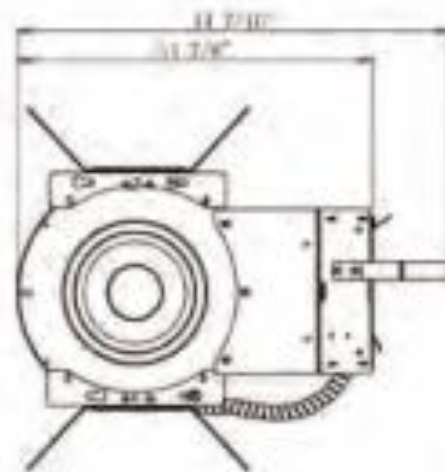
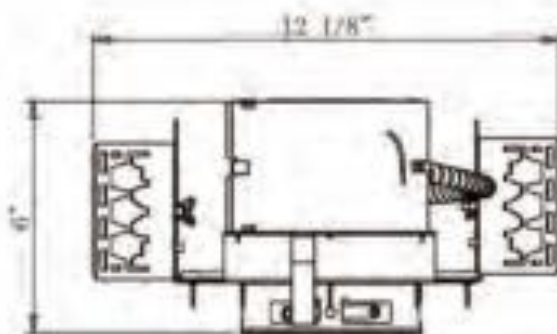

# ECO-LITE

## PRODUCTS

### REFLECTOR

- High quality reflector with 1.2mm thickness. Optional painted white flange is available.
- Reflector easily wires to dedicated frame with locking quick connect.

### FRAME

- Constructed from 16-gauge steel, die- formed construction for max heat dissipation and rust protection.

### LED Module

- Cree true white technology available
- CRI>90%
- Color temperature: 3000K-5000K
- Rated for 50,000 hours at 70% lumen output
- No heat, mercury or UV

# ECO-LITE

## PRODUCTS

### ELECTRICAL SYSTEM

- Thermal protection guard protects the LED module from overheating and will dim LED module if necessary
- PF>0.9
- Fully dimmable down to 10% of initial light
- Output with a 0-10 volt dimmer

INPUT POWER	LUMENS
25W (+/- 5%)	2000LM

### MOUNTING

- Designed to install into an existing downlights mounting frame and convert them into energy efficient LED downlights.
- Flex is designed to attach into existing junction box.
- Vertically adjustable universal mounting brackets accept flat bar hangers, conduit or C-channel.
- The reflector assembly is held in with 4 “butter-fly” spring clips.
- Reflector quickly attaches with lockable quick connect. Hanger bars ordered separately.
- Compatible with C-channel, flat bar wood joist bar hanger and EMT.

# ECO-LITE

## PRODUCTS

### JUNCTION BOX

- Plaster frame integrated 29 cubic inch 0.064" thick galvanized steel
- Provided with four ½" knockouts, one ¾" knockout and four Romex knockouts with true pry out slots and strain clamps
- Designed for straight through conduit runs. Electrical connections are made through a single junction box door.
- Green wire provided for installation with a ground wire fed through PVC pipe conduit.

### THERMAL PROTECTION

- External thermal device is located on the junction box wrap.

### DRIVER

- The LED driver is mounted to the J-box cover and is accessible from below the ceiling.
- Rated for 50Hz to 60Hz at 120V/277V input.
- Produces less than 20% THD.

### CLEARANCE

- Frames require a minimum clearance of 3" ring from thermal insulation and 1/2" from adjacent building component.